



ARETAIL

carretera de sabadell 2

RUBÍ

+34 932 931 905 // +34 918 005 468

www.aretail.es

carretera de sabadell 2

Rubí



ZONE DESCRIPTION

Magnificent opportunity, commercial premises located in the municipality of Rubí, in the province of Barcelona.

It is a local with very good facade, at street level that has 345 sqm distributed on the first floor. It is located in an area where we can find a high volume of stores and services. So it is a perfect location for any activity.

It has good communication by public transport:

Subway: S7

Train: S1

Bus: 1, 2, B8, C6, L12

If you are looking for a local in a well communicated area, do not hesitate and contact us for more information!



PROPERTY DESCRIPTION

CURRENT TENANT	NO TENANT
STORE	SURFACE m ²
Ground floor	345 m ²
TOTAL	345 m²



ECONOMICS INFORMATION

Asking price	€ 1,958 + taxes
Professional Fees	15% of the annual rent or the average of the escalation + taxes



carretera de sabadell 2

Rubí

PROPERTY | PICTURES



carretera de sabadell 2

Rubí

PROPERTY | PICTURES



carretera de sabadell 2

Rubí

PROPERTY | PICTURES



carretera de sabadell 2

Rubí

PROPERTY | PICTURES



carretera de
sabadell 2

Rubí

PROPERTY | PICTURES

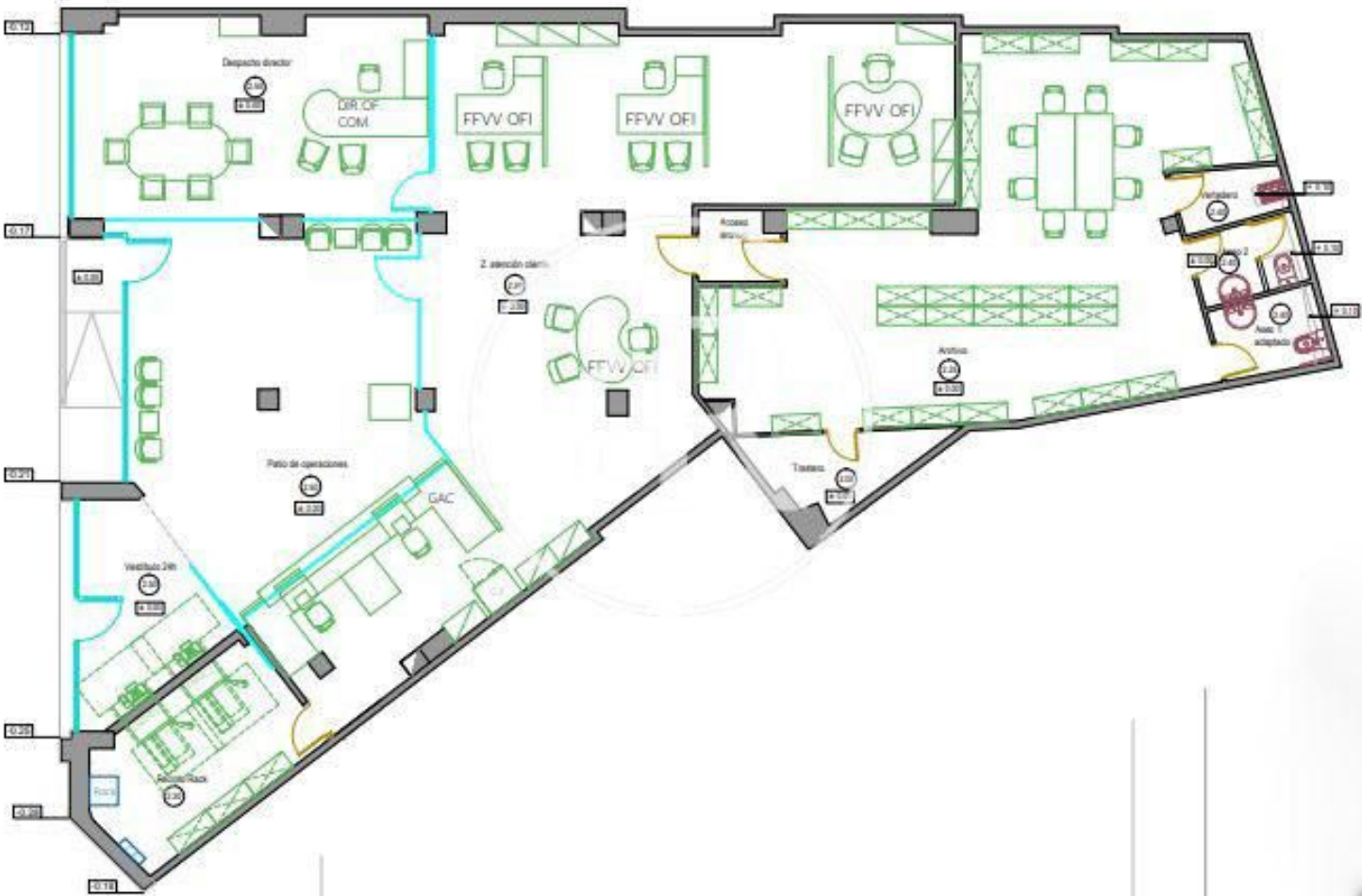

carretera de
sabadell 2

Rubí

PROPERTY | PICTURES



carretera de sabadell 2

Rubí

PROPERTY | PICTURES



carretera de sabadell 2

Rubí

PROPERTY | PICTURES





Passeig de Gràcia, 85, 8^a planta
+34 935 288 909 • 08008 Barcelona

Serrano, 60, 4^a planta
+34 918 005 465 • 28001 Madrid

www.aretail.es

This information has been prepared by ARETAIL, with different information about the market. With the acceptance of this document, the recipient of the same undertakes not to copy, reproduce or distribute this Confidential Document to third parties, neither in its entirety nor in part, without the prior consent of ARETAIL, expressed in writing, as well as to keep permanently confidential all the information contained therein and that is not in the public domain

This Confidential Document has been prepared in order to provide general information about the real estate market. Although the information contained in this document is considered to reflect the true image of it, ARETAIL expressly declines all responsibility for the statements, express or implied, contained in this Confidential Document, for its omissions, or for any other oral or written communications made to any interested party.

Nothing contained in this Confidential Document is a promise or forecast for the future. ARETAIL reserves the right to request the future return of this Document at any time.