



# ARETAIL

avinguda alcalde porqueres 60

---

LLEIDA

+34 932 931 905 // +34 918 005 468

[www.aretail.es](http://www.aretail.es)



# avinguda alcalde porqueres 60 Lleida



## ZONE DESCRIPTION

Magnificent opportunity, retail space located in the Balaría neighborhood, in the city of Lleida.

It is a premises at street level that has 253 sqm distributed on the ground floor, is located in one of the main arteries of Lleida and a few meters from Plaça Europa and Passeig de l'Onze de Setembre, where we find a large number of shops, as well as services such as schools, banks, gyms...

Therefore, it is a very good area to start any commercial activity, given that there is a high volume of both pedestrian and vehicular traffic.

If you are looking for a place in a commercial area, do not hesitate and contact us for more information!



## PROPERTY DESCRIPTION

CURRENT TENANT	NO TENANT
STORE	SURFACE m <sup>2</sup>
Ground floor	253 m <sup>2</sup>
TOTAL	253 m <sup>2</sup>



## ECONOMICS INFORMATION

Asking price	€ 1,350 + taxes
Professional Fees	15% of the annual rent or the average of the escalation + taxes



avinguda  
alcalde  
porqueres 60  
Lleida

PROPERTY | PICTURES





avinguda  
alcalde  
porqueres 60  
Lleida

PROPERTY | PICTURES



avinguda  
alcalde  
porqueres 60  
Lleida

PROPERTY | PICTURES





avinguda  
alcalde  
porqueres 60  
Lleida

PROPERTY | PICTURES



avinguda  
alcalde  
porqueres 60  
Lleida

PROPERTY | PICTURES





**avinguda  
alcalde  
porqueres 60**  
Lleida

PROPERTY | PICTURES





**avinguda  
alcalde  
porqueres 60**  
Lleida

PROPERTY | PICTURES



avinguda  
alcalde  
porqueres 60  
Lleida

PROPERTY | PICTURES

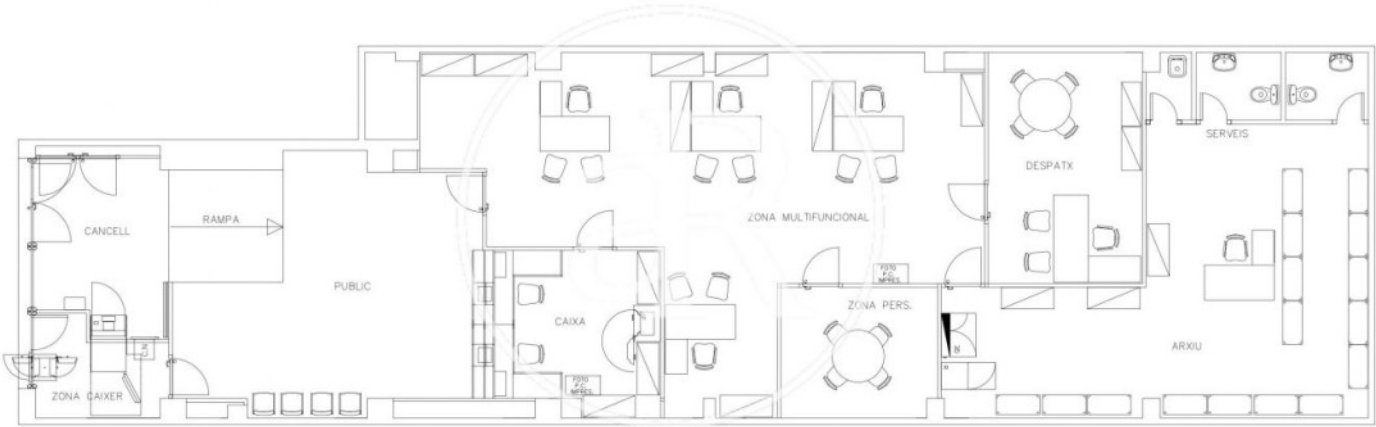





Passeig de Gràcia, 85, 8<sup>a</sup> planta  
+34 935 288 909 • 08008 Barcelona

Serrano, 60, 4<sup>a</sup> planta  
+34 918 005 465 • 28001 Madrid

[www.aretail.es](http://www.aretail.es)

This information has been prepared by ARETAIL, with different information about the market. With the acceptance of this document, the recipient of the same undertakes not to copy, reproduce or distribute this Confidential Document to third parties, neither in its entirety nor in part, without the prior consent of ARETAIL, expressed in writing, as well as to keep permanently confidential all the information contained therein and that is not in the public domain

This Confidential Document has been prepared in order to provide general information about the real estate market. Although the information contained in this document is considered to reflect the true image of it, ARETAIL expressly declines all responsibility for the statements, express or implied, contained in this Confidential Document, for its omissions, or for any other oral or written communications made to any interested party.

Nothing contained in this Confidential Document is a promise or forecast for the future. ARETAIL reserves the right to request the future return of this Document at any time.